



513/250 Elizabeth Street MELBOURNE, VIC



1



1

Perfect Investment or Pied-a-Terre

- Super central location, Corner of Lonsdale & Elizabeth St
- Apartment faces West overlooking Elizabeth St
- Bright sunny aspect
- Clever layout leaves no wasted space
- Generous feel throughout
- Perfect for business stop overs or kids at university
- Quick, easy access to main shopping hubs
- Secure building, lift access to floor
- Communal pool, spa, gym & outdoor area
- Serviced by all public transport including free tram zone
- Sold with furniture as inspected & inventoried in the section 32
- Potential rent furnished \$450.00 - \$500.00pw
- Potential rent unfurnished \$425.00 - \$450.00pw

For Sale

Type: Apartment

Dionne Wilson

0396648114

Harcourts Melbourne City, Estate Agents, specialising in sales & leasing of Warehouse, Heritage, Unique ? WHU properties

513/250 Elizabeth Street MELBOURNE

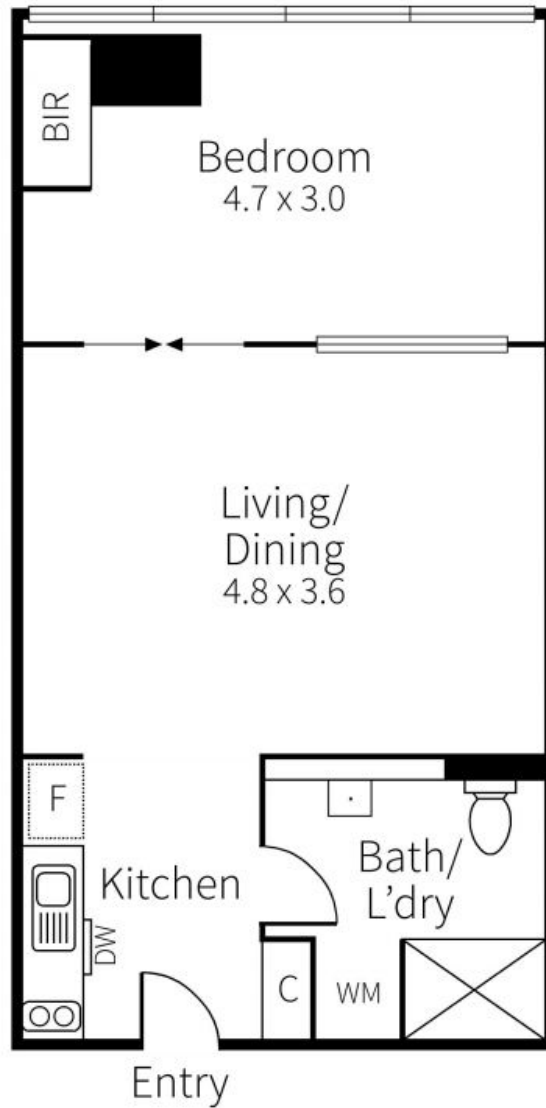

Every care has been taken to verify the accuracy of information provided.
Prospective purchasers are required to take such action as is necessary to satisfy themselves in all respects.